

---

## 目录表

一、承认书 (Pecification For Approval)	-----1
二、外形图 (Package Dimensions)	-----2
三、工作参数 (operational parameter)	---3
四、光电特性参数 (Typical Optical/Electrical Characteristics)	-----4
五、注意事项 ( matters need attention)	-----5

# SPECIFICATION FOR APPROVAL

## 承认书

CUSTOMER'S CODE

客户代码: \_\_\_\_\_

DESCRIPTION

品 名: \_\_\_\_\_ CZ504C/W \_\_\_\_\_

SPECIFICATION

规 格: \_\_\_\_\_ 5MM 白灯短脚 \_\_\_\_\_

DATE

送样日期: \_\_\_\_\_

PART NO.

本厂型号: \_\_\_\_\_

REFERENCE No.

档案号: \_\_\_\_\_

NUMBER OF SAMPLE

送样数量 \_\_\_\_\_

COPY OF ACKNOWLEDGEMENT

承认书份数 \_\_\_\_\_

Approved By Customer 客户承认	Qualified By 核 准	Form Designer 制 作

■ 外形图 (Package Dimensions) 单位: (Unit) : mm

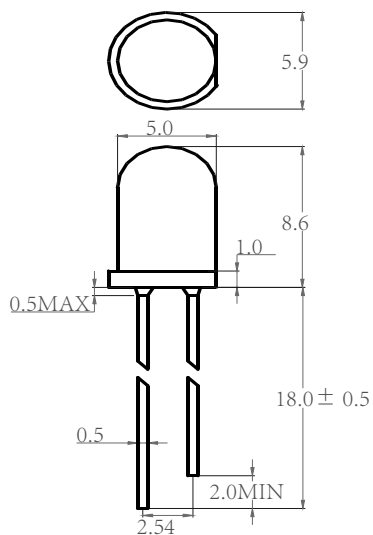

晶片 (CHIP)	
材质 (Material)	磷化铝镓铟 (InGaAIP)
颜色(Color)	白 (WHITE)
胶体 (Colloids)	
材质 (Material)	环氧树脂 (Epoxy)
颜色(Color)	Transparent

■ NOTES注意

- 1、 All dimension units are millimeters.
- 1、 所有尺寸单位均为毫米。
- 2、 All dimension tolerance is  $\pm 0.5\text{mm}$  unless otherwise noted.
- 2、 除非另有说明,  $\pm$  尺寸公差为 0.5mm。
- 3、 An epoxy meniscus may extend about 1.5mm down the leads.
- 3、 环氧弯月板可沿引线延伸约 1.5毫米。
- 4、 Burr around bottom of eqoxy may be 0.5mm max
- 4、 赤道面底部周围的毛刺最大可能为 0.5mm

**■ Absolute Maximum Rating 极限工作参数**

Item 项目	Symbol 代号	Absolute Maximum Rating 极限工作参数	Unit 单位
Forward Current 正向电流	IF	20	mA
Peak Forward Current 瞬间脉冲电流	IFP	50	mA
Reverse Voltage 反向电压	VR	5	V
Power Dissipation 消耗功率	PD	100	mw
Electrostatic discharge 静电释放	ESD	1000	V
Operation Temperature 工作温度范围	TOPR	-25 ~ +80	℃
Storage Temperature 存放温度范围	TSTG	-40 ~ +80	℃
Lead Soldering Temperature 最高焊接温度	TSOL	300 ℃ for 3sec Max。	

\*Ifp Conditions: Pulse Wide ≤ 10msec ≤ 1/10 瞬间脉冲电流

\*Tsol Conditions: 3mm from the base of epoxy bulb 最高焊接温度 距胶体 3mm

## ■ Typical Optical/Electrical Characteristics 光电特性参数

Item 项目	Symbol 代号	Condition 测试条件	Min 最小值	Typ 典型值	Max 最大值	Unit 单位
Forward Voltage 正向电压	VF	IF=20mA	3	3.1	3.2	V
Light intensity 光强度	IV	IF=20mA	12000	14000	16000	mcd
Wavelength 波长	WD	IF=20mA	8000	/	10000	K
Peak Wave Length 峰值波长	$\lambda_p$	IF=20mA	/	/	/	K
Reverse current 逆向电流	IR	IF=20mA	0	/	5	uA
Viewing Angle 半光全角	$2\theta 1/2$	IF=20mA	/	30	/	deg
Recommend Forward Current 持续正向电流	IF(rec)	IF=20mA	0	/	30	mA

■ 注：本公司所提供的 **LED** 产品可根据客户需求订做，相关技术参数会发生变化，详细情况请咨询我公司有关人员。

## ■ Notes 附注

1. Work absolute ratings  $T_a=25^\circ\text{C}$  工作常规值 温度= $25^\circ\text{C}$
2. Tolerance of measurement of forward voltage  $\pm 0.1\text{V}$  正向电压误差范围  $\pm 0.1\text{V}$
3. The measurement tolerance of the peak wavelength  $\pm$  is 2nm 峰值波长  $\pm$  为 2nm 的测量公差
4. Measurement tolerance of luminescence intensity  $\pm 15$  发光强度的测量公差  $\pm 15$

## ■ matters need attention 注意事项

### (一) LED welding conditions LED焊接条件

(1) soldering iron: the tip temperature of soldering iron (maximum 30W) shall not exceed 300 ° C; soldering iron shall be grounded and the electrostatic field shall not exceed the range; soldering time shall not exceed 3 seconds; and the soldering position shall be at least 3 mm away from the colloid.

(1) 烙铁焊接：烙铁（最高 30W）尖端温度不超过 300℃；烙铁必需接地，静电不能超范围；焊接时间不超过 3秒；焊接位置至少离胶体 3毫米。

(2) immersion welding: the highest temperature of immersion welding is 260 ° C; the time of immersion welding is not more than 5 seconds; the position of immersion welding is at least 3 mm away from colloid.

(2) 浸焊：浸焊最高温度 260℃；浸焊时间不超过 5秒；浸焊位置至少离胶体 3毫米。

### (二) Pin Shaping引脚成形方法

(1) It is necessary to be 2 mm from the colloid to bend the bracket.

(2) The support forming must be done with clamture or by professional personnel.

(3) The support forming must be completed before welding.

**(4) The pin and spacing are the same as on the circuit board.**

- (1) 必需离胶体 2毫米才能折弯支架。
- (2) 支架成形必须用夹具或由专业人员来完成。
- (3) 支架成形必须在焊接前完成。
- (4) 支架成形需保证引脚和间距与线路板上的一致。

**(三) LED installation method LED安装方法**

(1) Pay attention to the external arrangement of all kinds of devices to prevent the wrong polar installation. Devices should not be too close to the heating element, and the working conditions should not exceed the specified limit.

(2) Do not install LED under pin deformation.

(3) When it is decided to install in the hole, calculate the size and tolerance of the face and the hole distance on the circuit board to avoid excessive pressure on the support.

(4) When installing LED, it is recommended to use guide sets for locate.

(5) Avoid exposing the LED to any shock before the welding temperature returns to normal

注意各(类)器件外线的排列，以防极性装错。器件不可与发热元件靠得太近，工作条件不要超过其规定的极限。

(2) 务必不要在引脚变形的情况下安装 LED。

当决定(在)孔中安装时，计算好面孔及线路板上孔距的尺寸和公差以免支架受过度的压力。

(4) 安装 LED时，建议用导套定位。

---

(5) 在焊接温度回到正常以前，必须避免使 LED 受到任何的震动或外力。

#### (四) Cleaning清洗

Special care must be taken when cleaning colloids with chemicals, as some chemicals have damage to the colloidal surface and cause fading such as trichloroethylene, acetone, etc. It can be wiped and soaked with ethanol for no more than 3 minutes at room temperature.

当用化学品清洗胶体时必须特别小心，因为有些化学品对胶体表面有损伤并引起褪色如三氯乙烯、丙酮等。可用乙醇擦拭、浸渍，时间在常温下不超过 3分钟。